716048

SP4E7

GN1/1 ELECTRIC CHIP-SCUTTLE TOP



- Electric chip scuttle (40 cm), top version.
- Power: 1 kW.
- Height-adjustable rubberised plastic feet (15-25 mm).
- AISI 304 stainless steel worktop and Scotch Brite finish with internal side-by-side joining system.
- AISI 304 stainless steel control panel and side panels.
- Heating through a lamp with ceramic-cast infrared heating element
- Supplied with removable GN 1/1 H150 mm container with false bottom for oil dripping, both in AISI 304 stainless steel.
- Energy regulator 1-6-Infinite.
- Technical compartment for easy connection to the electrical network.

TECHNICAL DATA

TOTAL POWER	1 kW	ELECTRIC POWER	1 kW
FREQUENCY	50/60 Hz	VOLTAGE	220-240 ~ V
TANK CAPACITY	GN1/1	TANK DIMENSIONS	32,5x53x15 cm
MINIMUM POWER CABLE CROSS-SECTION	3 x 1,5 n° - mm ²	ELECTRIC CABLE TYPE	H07 RN-F
TANK TYPE	AISI 304	ELECTRICAL CONNECTION HEIGHT (H)	35 mm
ELECTRICAL CONNECTION HEIGHT (X)	321 mm	ELECTRICAL CONNECTION HEIGHT (Y)	-63 mm
FOOT HEIGHT	15 mm	FOOT ADJUSTMENT	15/25 mm
IPX RATING	4	WIDTH	40 cm
DEPTH	70 cm	HEIGHT	28 cm
PACKAGE WIDTH	79,0 cm	PACKAGE DEPTH	47,0 cm
PACKAGE HEIGHT	59,0 cm	NET WEIGHT	16,4000 kg
GROSS WEIGHT	22 kg	VOLUME	0,2200 m ³
HARMONISED CODE	84198180		

ACCESSORIES

799506 PAIR OF CLOSING ELEMENTS (L=70CM)

INSTALLATION SCHEMES

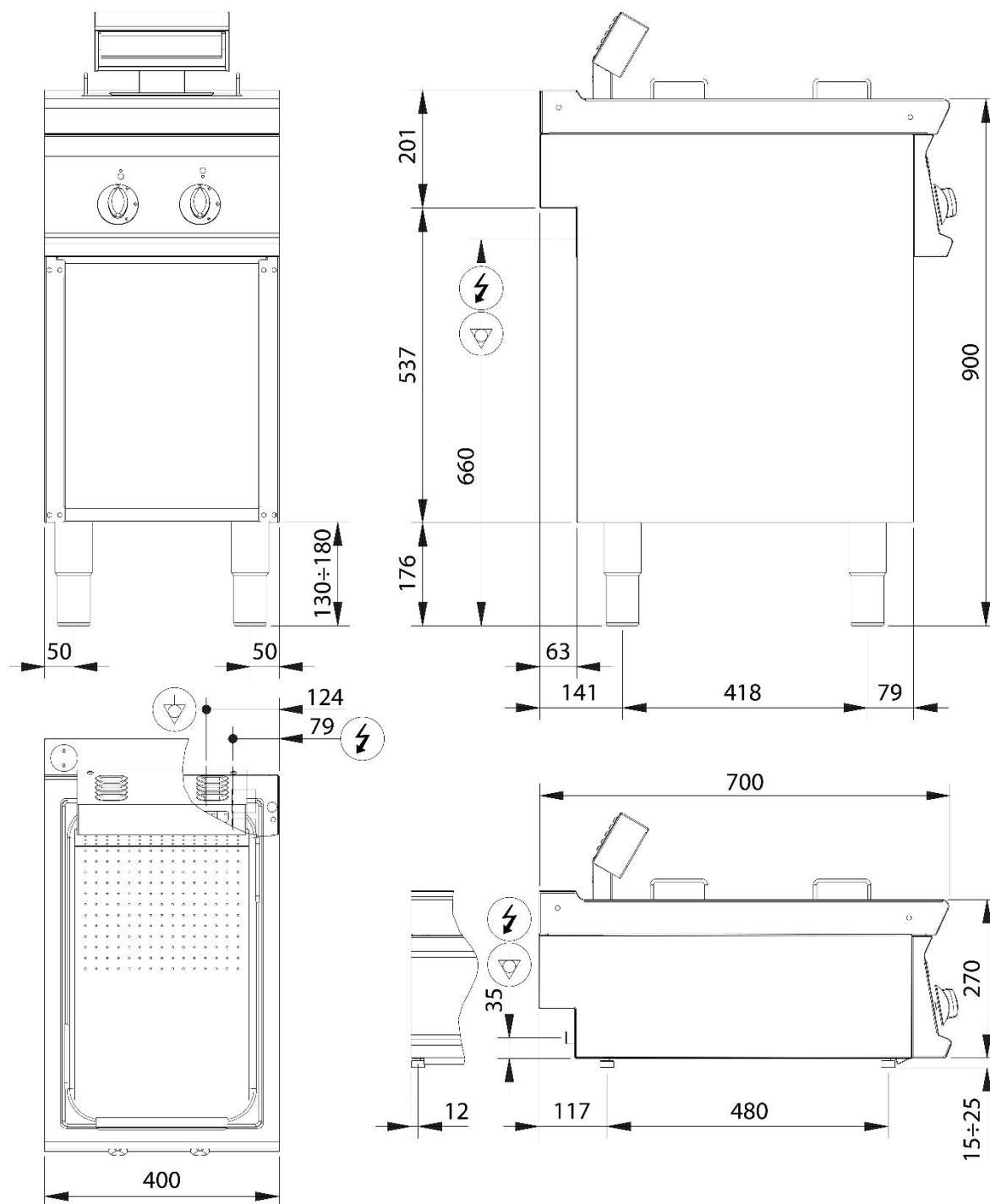

Fig.1 | Abb.1 | рис.1 - 5415.652.00