

---

**716049**

SP4FE7

**GN1/1 FREESTANDING ELECTRIC CHIP SCUTTLE  
ON OPEN CABINET**

---



- Freestanding chip scuttle on an open cabinet (40 cm).
- Power: 1 kW.
- AISI 304 stainless steel height-adjustable feet (133/195 mm)
- AISI 304 stainless steel worktop and Scotch Brite finish with internal side-by-side joining system.
- AISI 304 stainless steel control panel and side panels.
- Heating through a lamp with ceramic-cast infrared heating element
- Supplied with removable GN 1/1 H150 mm container with false bottom for oil dripping, both in AISI 304 stainless steel.
- Energy regulator 1-6-Infinite.
- Technical compartment for easy connection to the electrical network.

## TECHNICAL DATA

TOTAL POWER	1 kW	ELECTRIC POWER	1 kW
FREQUENCY	50/60 Hz	VOLTAGE	220-240 ~ V
TANK CAPACITY	GN1/1	CABINET DIMENSIONS	33x57,4x39,5 cm
TANK DIMENSIONS	32,5x53x15 cm	MINIMUM POWER CABLE CROSS-SECTION	3 x 1,5 n° - mm <sup>2</sup>
ELECTRIC CABLE TYPE	H07 RN-F	TANK TYPE	AISI 304
ELECTRICAL CONNECTION HEIGHT (H)	660 mm	ELECTRICAL CONNECTION HEIGHT (X)	321 mm
ELECTRICAL CONNECTION HEIGHT (Y)	-63 mm	FOOT HEIGHT	155 mm
FOOT ADJUSTMENT	155/250 mm	IPX RATING	4
WIDTH	40 cm	DEPTH	70 cm
HEIGHT	90 cm	PACKAGE WIDTH	81 cm
PACKAGE DEPTH	47,0 cm	PACKAGE HEIGHT	114,0 cm
NET WEIGHT	24,0000 kg	GROSS WEIGHT	36,4 kg
VOLUME	0,4300 m <sup>3</sup>	HARMONISED CODE	84198180

## ACCESSORIES

319002	STAINLESS STEEL RH/LH DOOR FOR TECNO74, TECNO90, MOSAICO74, MOSAICO90
719004	TECNO74 REAR COVERING PANEL FOR FREESTANDING ELEMENTS (L=40CM)
799503	SIDE COVERING PANEL FOR FREESTANDING MODULE
799506	PAIR OF CLOSING ELEMENTS (L=70CM)

## INSTALLATION SCHEMES

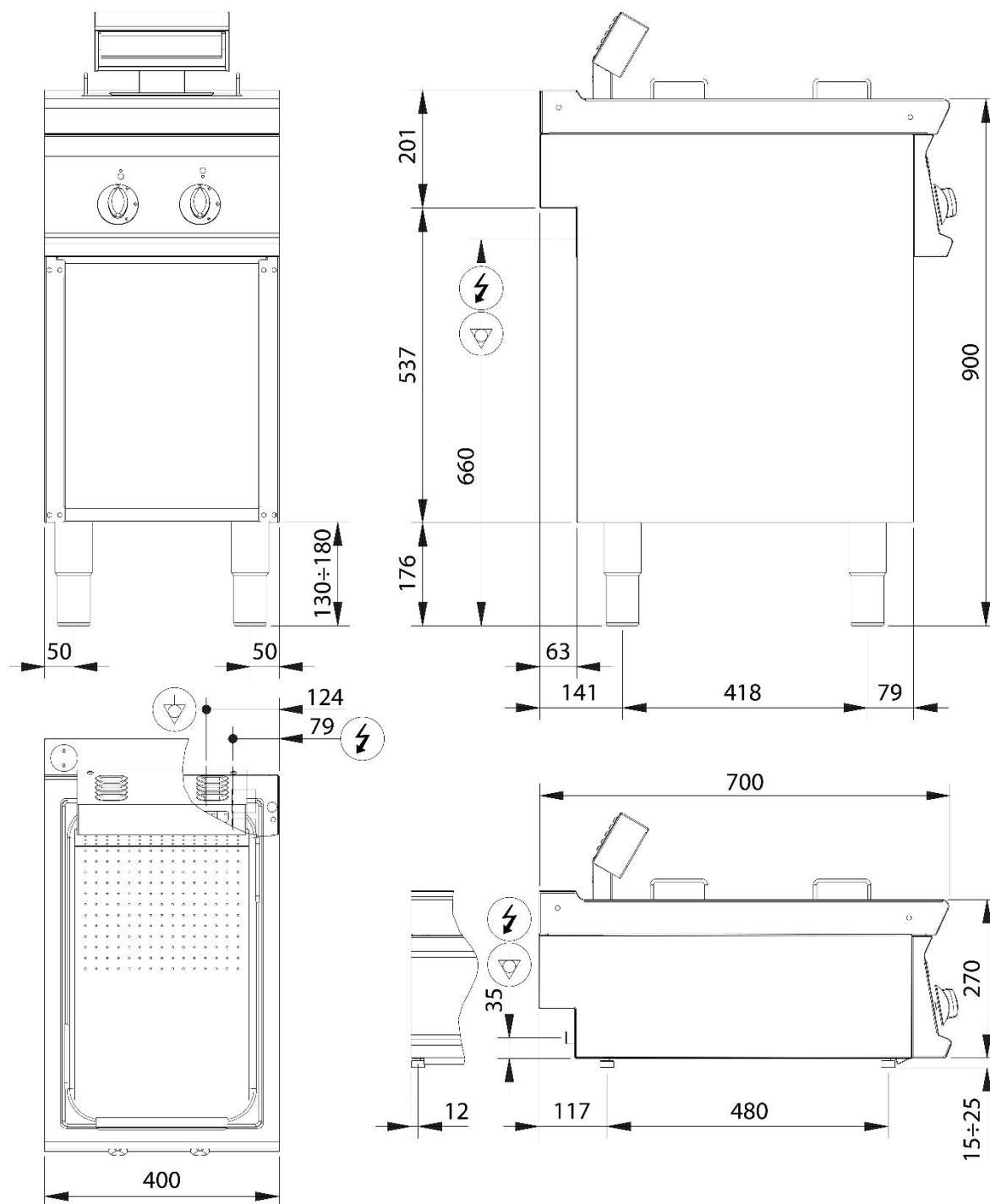

Fig.1 | Abb.1 | рис.1 - 5415.652.00